



2215 IH 45
League City, TX. 77573
281-332-0511
Fax: 281-554-2592

6612 Harborside Drive
Galveston, TX. 77554
409-744-7131
Fax: 409-744-7131
Email: afence@afence.com

3501 N. IH 35
Georgetown, TX. 78628
512-930-4000
Fax: 512-930-4002
www.afence.com

INSTALLING YOUR CHAINLINK FENCE

by American Fence & Supply Co., Inc.

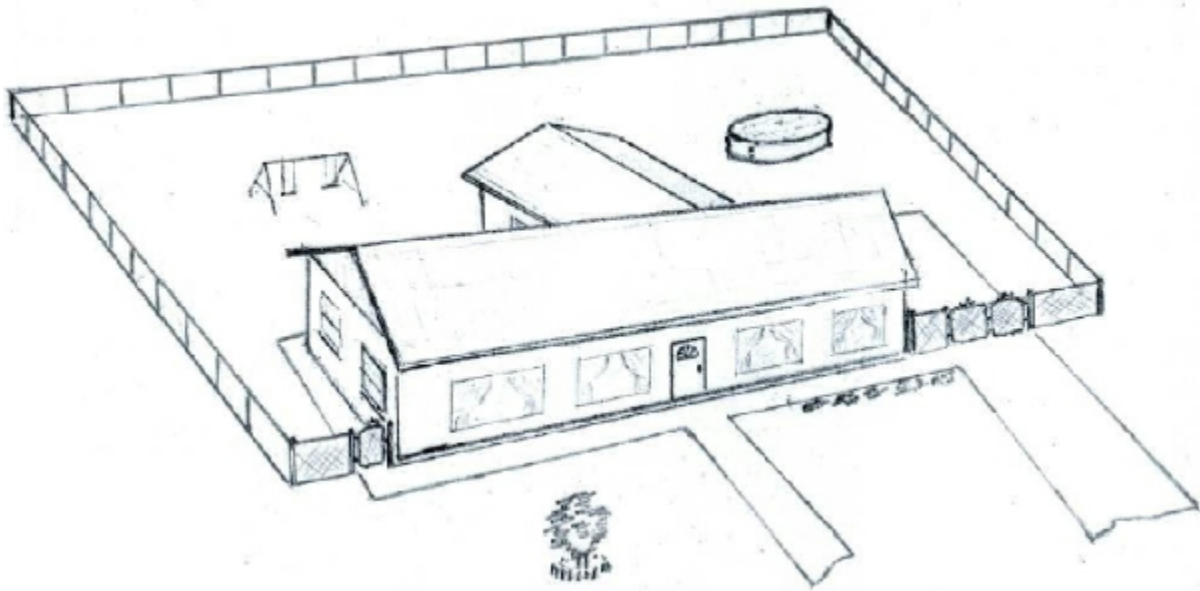

Step 1: Layout of Fence

Determine where your property lines are located and your desired Terminal Post locations will be. Proper determination of property lines is the responsibility of the property owner. Terminal Posts are your End, Corner and Gate Posts. In the diagram below, Terminal Posts are indicated by a small Red Dot >>●<<. There are 9 of them in the diagram. Mark these desired locations with a small wooden or metal stake.

Note: For using pre-made gates, refer to Step 10. This step will give you the proper width to set posts on either side of the gate opening.

Important: Customer is solely responsible for determining product compliance with all city, county, state and federal codes, restrictions, ordinances, or permit requirements. Also, prior to any digging or excavation, Texas state law requires a 48 hour notice to the "ONE CALL SYSTEM OF TEXAS" (Ph#1-800-545-6005). If you are not in Texas, please call your local or state utilities protection service.

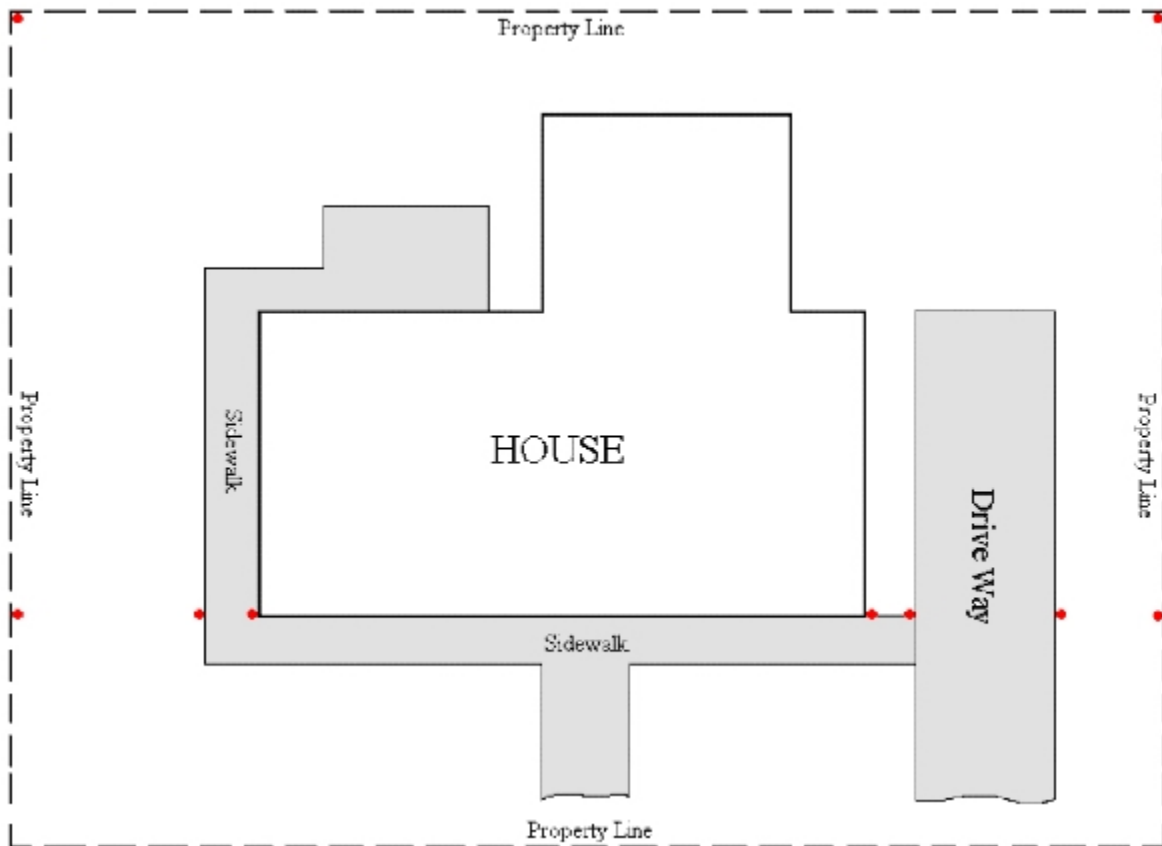

Step 2: Set & Level All Terminal Posts In Concrete

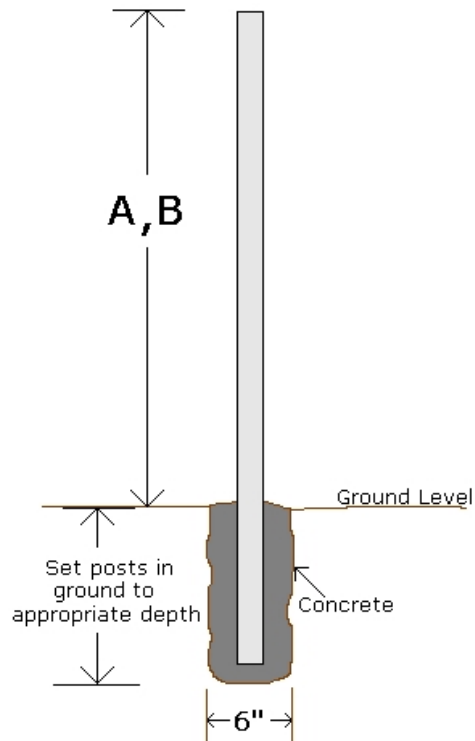

A : Use a one piece cap

- For 4' tall fence, **A**= 47" out of ground
- For 5' tall fence, **A**= 59" out of ground
- For 6' tall fence, **A**= 71" out of ground



B : Use a 3-piece setup (Brace Band, Rail End Cup & Dome Cap)

- For 4' tall fence, **B**= 48" out of ground
- For 5' tall fence, **B**= 60" out of ground
- For 6' tall fence, **B**= 72" out of ground

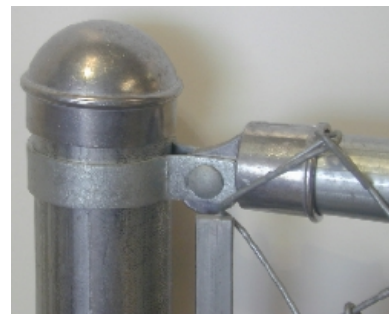

Step 3: Mark Location Of Line Posts

- Determine the actual distance of the section to be marked. (In this example 55' is the distance) Divide the distance by 10 and round your answer down to the next whole number. This is the required number of line posts. Ex/ $55' \div 10 = 5.5$. Round Down to 5. You will need 5 line posts for this section. If you place 5 line posts in between these 2 terminal posts, it will yield **6 sections** of fence. To determine the proper, equidistant spacing of line posts, divide the number of **sections** into the total distance. Ex/ $55' \div 6 = 9.166$ or $9' 2''$
- Stretch a piece of nylon string from the base of one terminal post to the base of the other. The string must come off one side of the post or the other. You want it to come off of the side your going to have the chainlink fabric on, usually the outside of the yard. Using this nylon string and spacing method above, mark the location of the line posts and dig the post holes 2" deeper than the depth you used for the terminal posts.

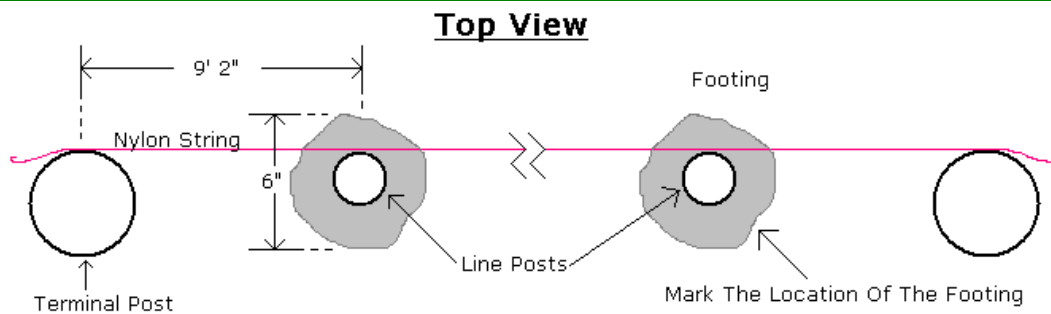
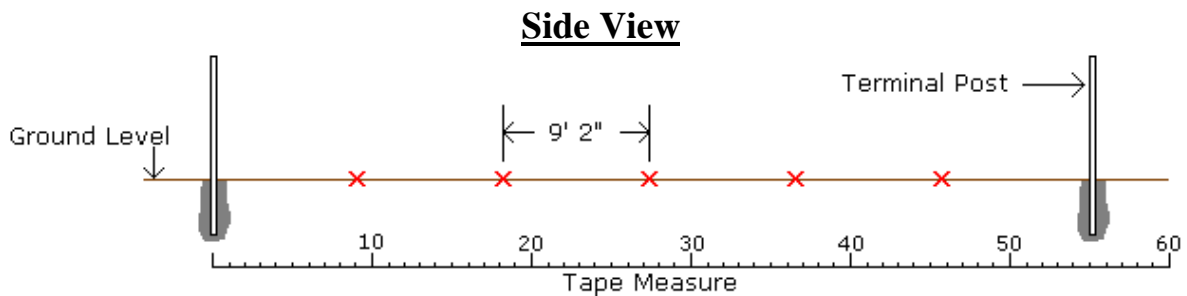

Step 4: Set & Level All Line Posts In Concrete

- Make a mark on all terminal posts 2" down from the top (with magic marker). Next, stretch your nylon string between the 2 terminal posts keeping you nylon string on the marks 2" down from the top. Use this line as a guide for the line posts. Set all line posts in concrete. This method should be used where the ground is fairly level. If it is not, ask an American Fence Salesperson for help.

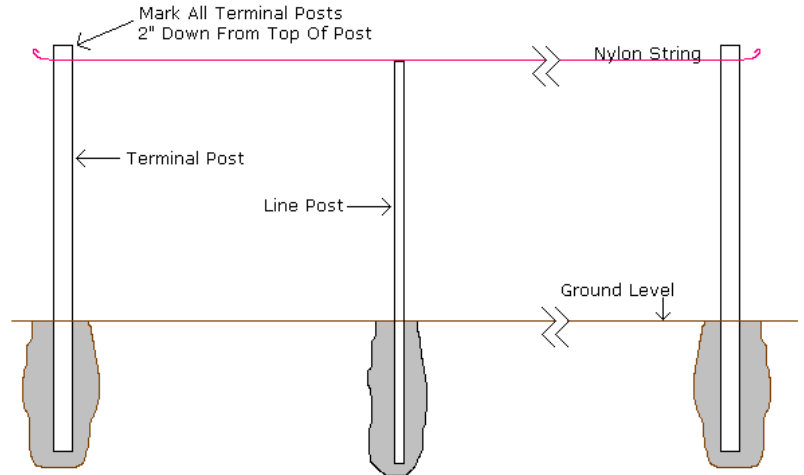

Step 5: Install Post Caps

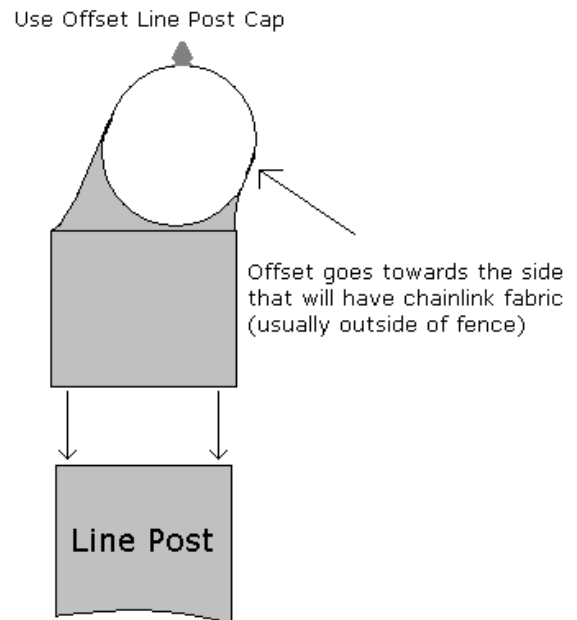
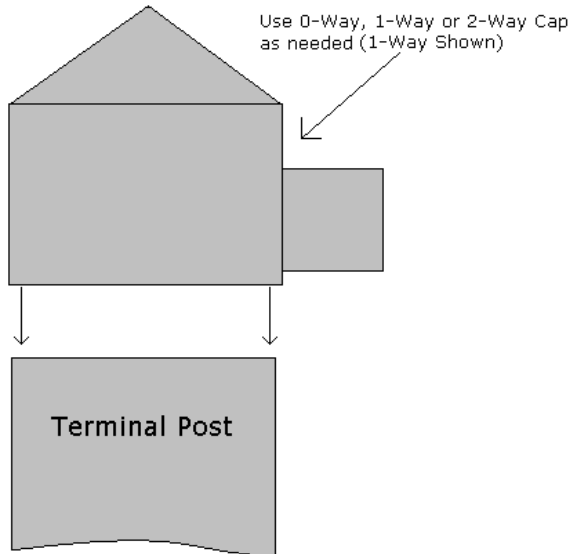

Parts Required For A 3-Piece Terminal Post Cap

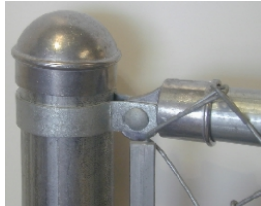

Brace Bands

One band is required per rail end cup



Rail End Cups

The cups are offset for a 2 directional terminal post. One cup points up and the other points down.



Dome Cap For Terminal Post
Still need Brace Band(s)
and Rail End Cup(s) to
complete 3 piece setup

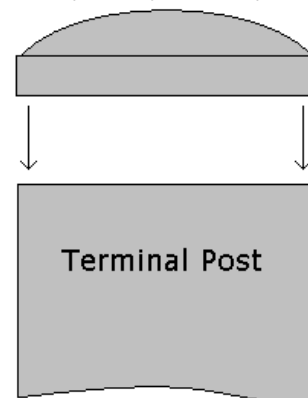

Step 6: Install Toprail & Base Wire(optional)

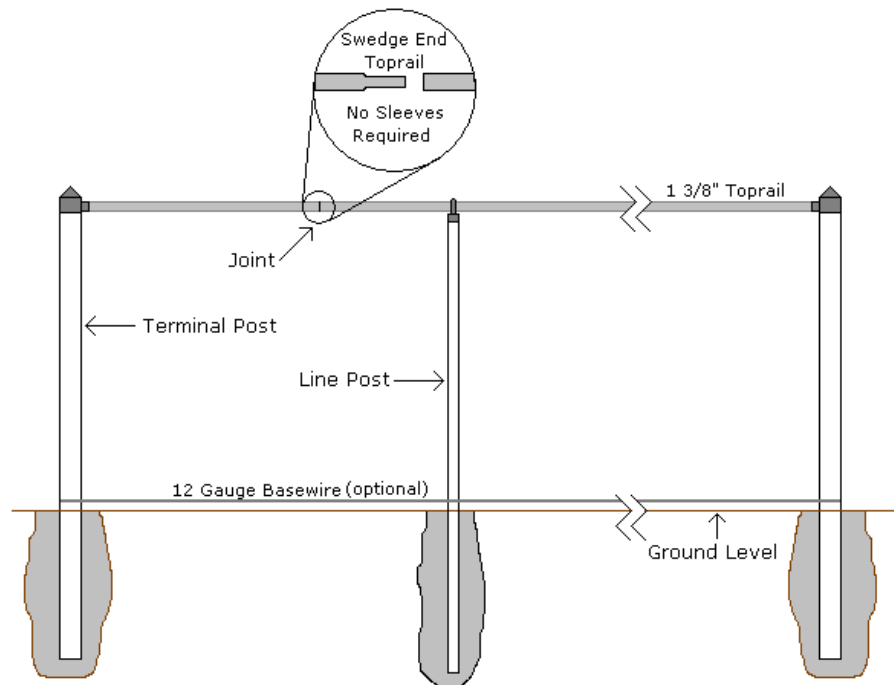

Top Rail

- Slide top rail through a couple loop caps and butt end firmly into the rail end cup on the 1-piece terminal post cap. If you have the 3-piece terminal post cap setup (dome cap, brace band & rail end cup), adjust height of rail end cup if necessary.
- Our top rail has a **swedged end**, which tapers down so it will fit into another piece of top rail. Fit the non-swedged end into the rail end cup at the end or corner posts. Add sections of rail, sliding each non-swedged end into a swedged end. Be certain to push rails toward your beginning point to 'seat' them all the way into each other. Push firmly. If the top rail has no swedged end then you need **sleeves** to join top rail together. Add additional top rail until you reach the next terminal post, i.e. end, corner, gate post.
- Cut excess rail off with hack saw or pipe cutter. Mark the cut-off point carefully so the rail will fit snugly into the rail end cup. Any slack in your entire length of rail will allow the chain link, when stretched tight, to pull the end posts in towards each other.
- Install top rail in all stretches of fence. At this point, visually check the height of line posts once top rail is installed. If a post is too high, remove rail and trim as necessary. If a post is 1/4" too short you may also cut a sliver of pipe, the same diameter size as the line post and slip it under the loop cap.

Base Wire (optional)

For each section of fence, stretch a piece of base wire from one terminal post to the next. Base wire should be installed 2" off of ground and on the same side that fabric will be going on. Attach base wire to line posts with aluminum tie wires, 2" off of ground.

Step 7: Roll Out Chainlink

- Roll out chainlink fabric in front of framework (usually on outside of fence).
- On 6' tall and higher, if you want the **Twists(points)** up on the fence, be sure to roll out the wire with the points away from the framework. If you want the **Knuckles** up on the fence, be sure to roll out the wire with the knuckles away from the framework.
- **Note:** 4' tall and 5' tall chainlink have Knuckles on top and bottom. Because of this, there is no need to distinguish which side of chainlink is rolled out away from the framework.

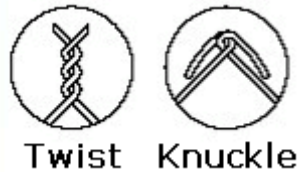

- Now stand up the end that is away from the roll, insert tension bar and attach to terminal post with tension bands.

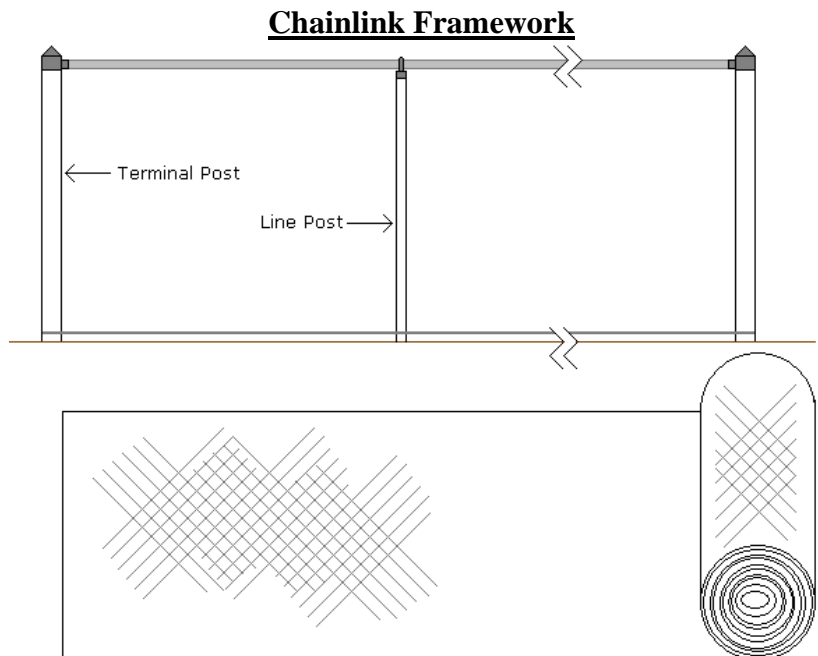
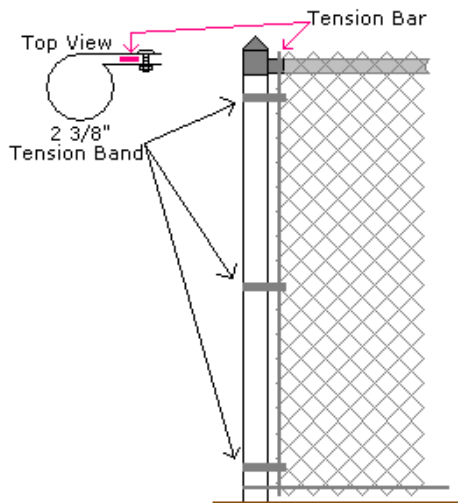

Step 8: Stretch Chainlink Fence

- Stand the wire up along the framework and loosely tie it about every 20 feet. This is only to keep chainlink from falling on you as you get further away from the terminal post.
- Let the wire extend on past the terminal post you are about to tie off to. Attach your **come-a-long** at the mid-point on this terminal post. Extend the come-a-long cable out about 8 feet or so. **Note: Come-a-long must be on the inside of the fabric and framework.**
- Drop a **tension bar** down through the chainlink fabric and attach to **come-a-long** with an A-Frame (**stretch tool**). If you don't have the A-Frame stretch tool, it can be simulated with something as simple as a piece of rope, wire or chain.
- Begin stretching the chainlink by pulling on the **come-a-long** ratchet bar. Make sure you are not snagged on the ground or grass and that the loose tie wires (you just installed) are not obstructing a clean and full stretch from one end to the other. **Do not** over-stretch the wire. The desired tightness is when you can put your fingers through the mesh and just barely squeeze the diamonds together.
- After stretching to desired tightness, you will be left with 4 to 5 feet of loose chainlink wire at the end of the stretch. Pull this wire as tight as you can manage by hand. Cut excess wire away (see picture).
- Insert the tension bar, install the bands, release the tension on the **come-a-long**.
- Straighten the chainlink and install the aluminum tie wires every 18" along the top rail and down each line post.
- (Optional) Pig ring the basewire to the chainlink every 18"-24"

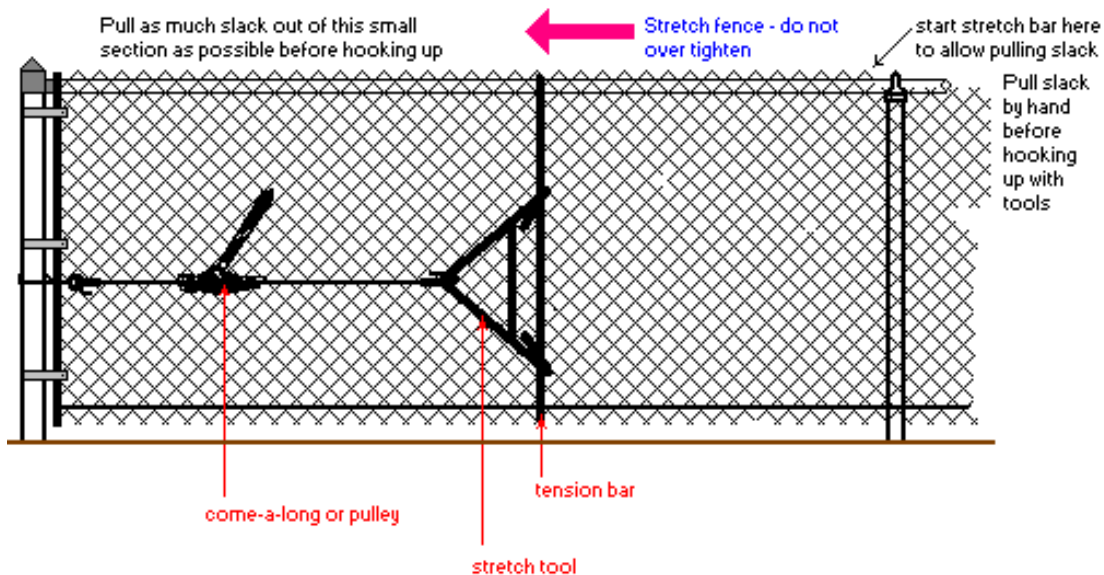

Cutting & Splicing Chainlink Fabric

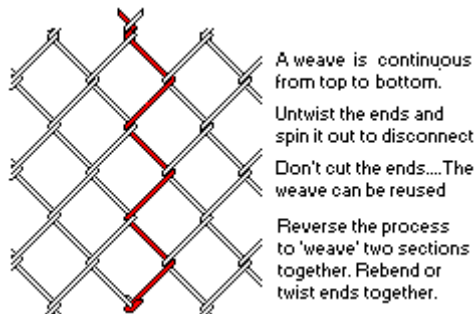

Step 9: Hang Gates

- For WALK Through gates, your gate opening should be 4" wider than the actual gate frame width.
- Common openings (inside post to inside post) for Walk gates: 39", 48", 61", 73", 97"

- For DRIVE Through gates, your gate opening should be 6" wider than the combined actual gate frame widths.
- Common openings (inside post to inside post) for Drive gates: 10', 12', 14', 16', 20'

- All gates are 3" shorter than stated height. This is for ground clearance.

